

Foot Brake, Ref. No. 584 530

Function:

By operating the foot brake the main motor is switched off and the main spindle is stopped by a mechanic brake.

Note:

The foot brake can only be mounted to machines with the "special safety" electric version.

MOUNTING THE FOOT BRAKE

Groups of the foot brake are re-assembled. In the exploded drawing every part is shown single.

- a) Insert the rod brake (1) into the left machine stand and its pin (A) into the hole of the right machine stand.

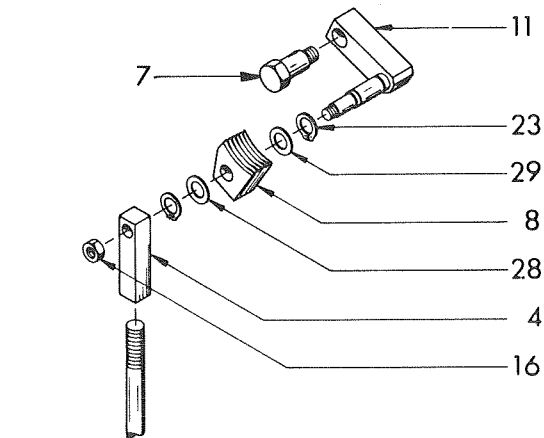

- b) Assemble the pivoting lever (5) to the bearing rod (6) with the two retaining rings (24). Mount the bearing rod (6) with the two washers (30) and hexagon head screws (2) to the machine stand.

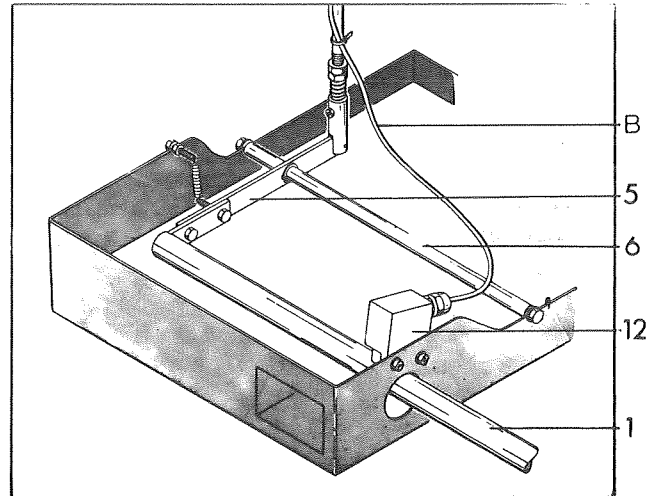

- c) Connect the arbor of the brake rod with the pivoting lever (5) by means of the hexagon head screw (20) and the clamping bolt (9). Mount the second clamping bolt (9) to the machine stand with the hexagon nut (16). Mount the tension spring (14) onto the two ends of the clamping bolts (9).

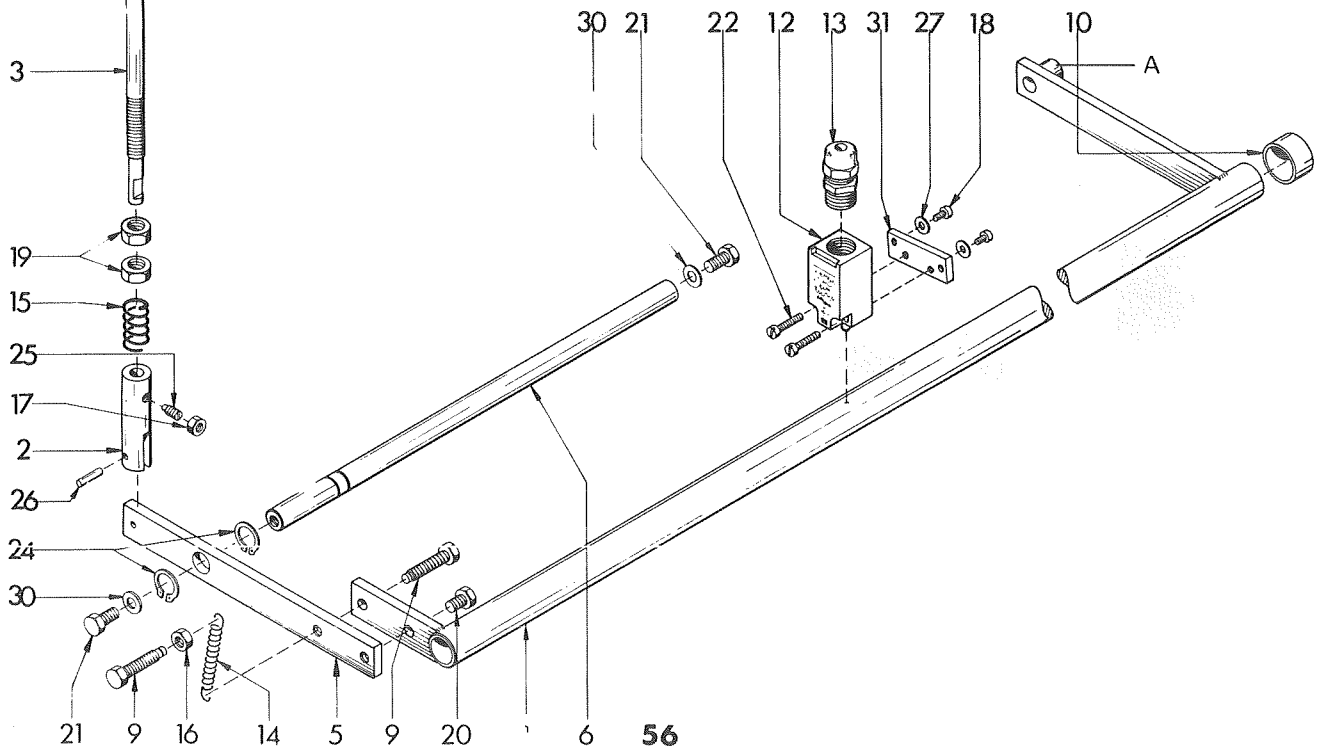

- d) Insert the pressure rod (3) through the top hole of the machine stand, put the compression spring (15) on the pressure rod and mount it to pressure bolt (2) with the set screw (25). The hexagon nut (17) is for securing the set screw.

Note:

- 1) The set screw must fit into the groove of the pressure rod.
 - 2) The pressure rod must not be fixed with the set screw. The set screw must only secure the pressure rod from slipping out of the pressure bolt.
- e) Preload the compression spring by screwing down the hexagon nut on the pressure rod (19) so that the distance pressure bolt - hexagon nut is approx. 20 mm. Secure the hexagon nut by countering the second one.
- f) Dismount the change gear cover. Mount brake mechanism with bolt (7). Remove the premounted adjusting nut (4) and thread it so far onto the pressure rod that space between brake block (8) and wheel is 1-2 mm in remounted condition. Therefore several trials will be necessary.

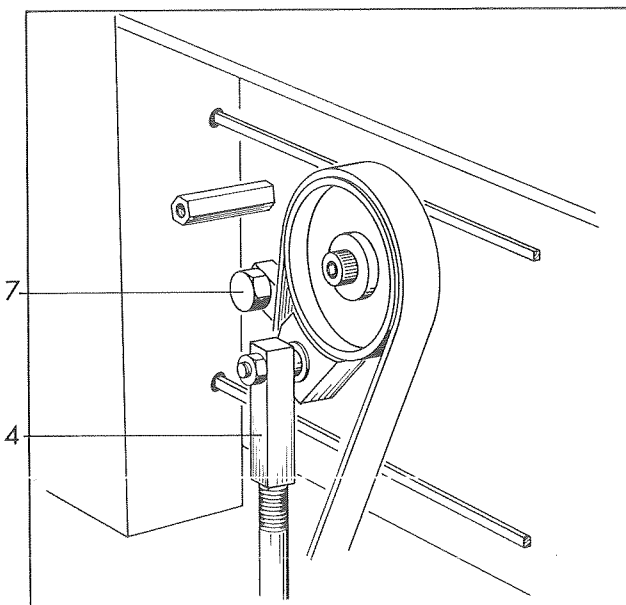

- g) Mount the limit switch (12) with flat head screws (22) to the adaptor plate (31). Fix adaptor plate to machine stand with bolts (18) and washers (27). Fix the cable (B) of the limit switch to the pressure rod.

Electrical connection of the limit switch

Dismount cable C which is clamped between limit switch of gear cover (b2) and e3.

Mount cable B of limit switch/foot brake

Connect one wire to e3, the other one to b2 (to the same contacts of the removed cable C).

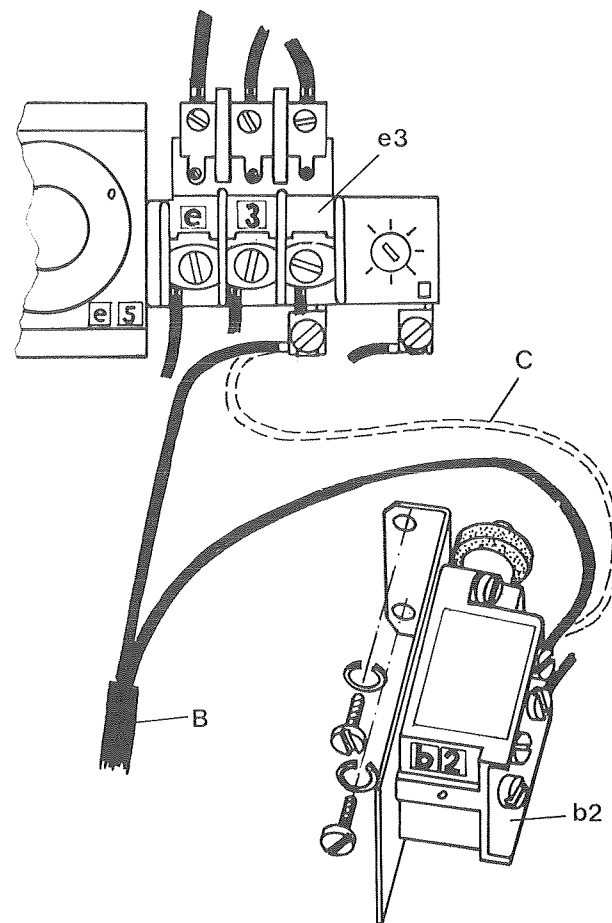

Adjustments:

The space of brake block can be adjusted with the nut (4). Completely worn brake blocks must be replaced.